

BELFAST PLATFORM FOR THE ARTS
2015/16 OPEN CALL FOR EXHIBITION PROPOSALS

DEADLINE FOR SUBMISSION: 28th FEBRUARY 2015

Platform Arts is accepting proposals from artists and curators, working in any media or discipline to be included in its 2015/2016 exhibition and events programme. Prior experience is not a condition of acceptance. Please refer to the guidelines before completing your proposal.

PROPOSAL FORMAT

Email your proposal as single PDF file to platformbelfast@gmail.com with "Exhibition Proposal: <Your Name>" in the subject line of the email. Please make sure your proposal includes the following:

- **CV (max 2 pages)** - Containing name, address, email, phone and website (if available)
- **Artist Statement (Max 500 words)**
- **Proposal Summary** - Please provide a summary (max 800 words) of the project you are proposing. This should cover the main themes of the work and outline how you intend to install it within the space. You can find a plan of the main gallery in our website <direct link>.
- **Supporting Material** - Please refer to the guidelines. All images and links for audio and video files should be contained within the body of the PDF file and captioned accordingly.
- **Funding** - Please provide details on how you plan to fund your exhibition, installation or event. Funding does not need to have been secured but we require a reasonable plan and backup plan of how you intend to fund. Platform can provide a letter of support to selected applicants to sustain individual fund seeking.
- **Further information** - Please provide any further information (max 800 words) that you feel is relevant to your proposal.

SUBMISSION GUIDELINES

- Proposals will only be accepted via email to platformbelfast@gmail.com
- Please include "Proposal: <Your Name>" in the subject line of the email
- The proposal must be completed and attached as a single PDF file including all supporting material. This should be titled Proposal <Your Name> and not exceed 10mb in size
- A max of ten items should be used to illustrate your work/proposal. All images should be contained within the body of the PDF file and captioned accordingly. Film and audio work should be uploaded in a web page (e.g. Vimeo (preferably), YouTube, artist website) and links provided within your PDF
- When referring to websites to support your proposal, you should provide the direct links for the particular pages/files you wished viewed and a brief explanation (50 words max) on what will be viewed
- Artist websites that supplement your biography are encouraged
- Platform will not accept proposal submissions that do not meet these guidelines

ELIGIBILITY

Platform seeks proposals from artists and curators from all backgrounds, working in any media or discipline. Prior experience is not a condition of acceptance.

THE GALLERY

This year's Platform Arts open call will coincide with the launch of our new gallery layout. This development is aimed to support a more diverse and extensive experience to exhibitors and visitors alike. What was originally our main gallery, a large single space, will be modified to bring together a resource/reception space, our Unit project space and main gallery on one floor.

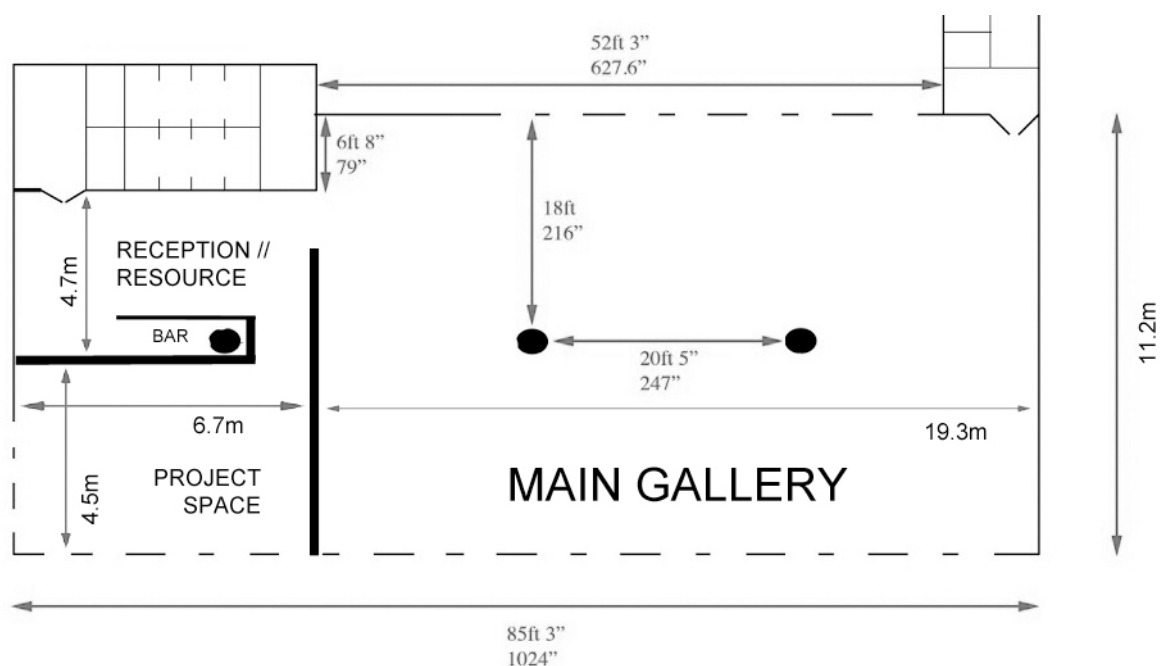

Unit Project Space & Main Gallery Floor Plan

Our main gallery, at roughly 209m², has a very adaptable framework. Our Unit project space provides opportunities for smaller interventions, exhibitions and installations. These spaces can be naturally lit or fully enclosed to the white cube aesthetic and contains an overhead system of movable halogen lights and power sockets located at ceiling height.



Main Gallery

FUNDING

Platform has limited financial resources and is unable to provide financial support to artists to realise an exhibition this includes costs of creating artwork, funding travel / transportation, installation, insurance on individual works etc.

Applicants should have a good idea of how they intend to fund their show. Platform can provide a letter of support and advice in applying for funding both in Northern Ireland and internationally. Artists must arrange their own technical support and should make allowances for costs associated with this in their exhibition budget.

SCHEDULING

Platform schedules shows throughout the year and will do its best to accommodate requested dates for exhibitions. This may not always be possible due to time or program restrictions. On average, a show runs for three weeks, with three days for installation and deinstallation. Wherever possible, Platform schedules the shows' opening nights for the first Thursday of the month. This is to coincide with Belfast's Late Night Art, which increases footfall for the opening night.

STORAGE

Due to limited space, Platform is unable to store works of art. All work must be removed from the premises during deinstallation.